

SYNRAD PS-48-12K Power Supply Quick Start Guide



Specifications:

Parameters		Model	
		PS-48-12K-US	PS-48-12K-EU
Output	Output Voltage	48V	
	Output Current	250A	
	Output Power	12000W	
Input	Voltage Range	90-264VAC	
	Frequency Range	47-63Hz	
	AC Current	32A/115AC, 22A/230VAC	
	Phases	3-Phase Plus Ground, Neutral Not Used	3-Phase Plus Neutral Plus Ground
Function	Power Factor (typ.)	0.98/230VAC at full load	
	Leakage Current	<7mA / 230VAC	
Environment	Remote Sense	Compensate voltage drop on the load wiring up to 0.5V.	
	Working Temp / Storage Temp	-40C to +70C / -40C to +85C	
	Working Humidity / Storage Humidity	20 to 90%RH / 10 to 95%RH Non-Condensing	
Safety and EMC	Vibration	10 to 500Hz, 2G	
	Safety Standards (Meanwell)	UL60950-1, TUV EN60950-1 Approved	
Others	EMC Emissions	Compliant to EN55022 (CISPR22) Conduction Class A, Radiation Class A, EN61000-3-2-3	
	EMC Immunity (Meanwell)	Compliance to EN61000-4-2, 3, 4, 5, 6, 8, 11, EN61000-6-2 (EN50082-2), Heavy Industry level, criteria 21x26.6x5.7 in. (533.4x674.1x142.9 mm)	
	Dimensions	21x26.6x5.7 in. (533.4x674.1x142.9 mm)	
	Weight	87lbs (39.5Kg)	

SYNRAD PS-48-12K Power Supply Quick Start Guide

SYNRAD

Setup:

1. Unbox the Power Supply: **save all the packaging for relocation if necessary.**



2. To set all **six power supplies into the rack**, slide the rear end of the unit in first locking it into place.



3. **Hook up the sense cable.** Assure the polarity is properly connected at the power input for the laser.

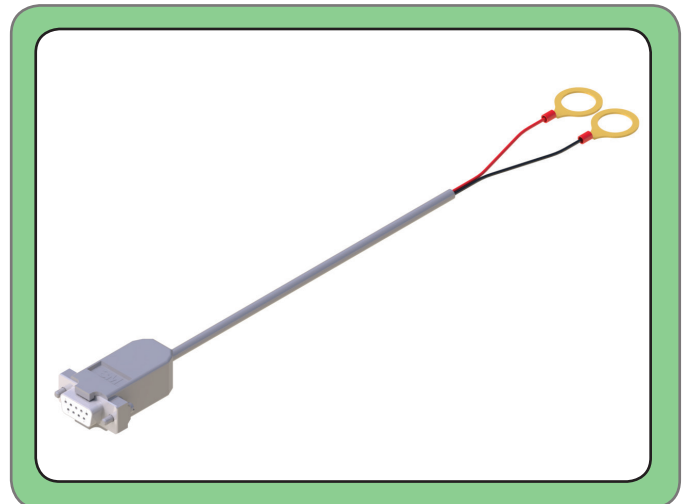

Power module will 'click' as it locks into place.

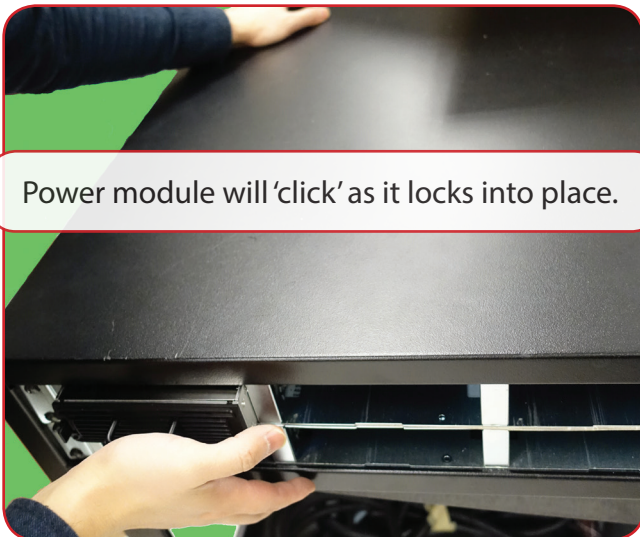

4. Connect **DC power** to the laser.

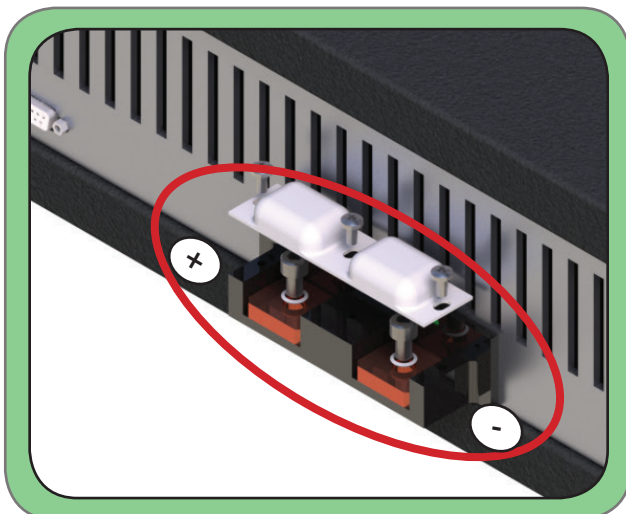

5. Hook in the **AC power.** **Note:** Assure L1, L2, L3, N and ground are correctly installed.

